

1	2	3	4		
RevNo	Revision note		Date	Signature	Checked
00	Sketch Only		02/05/25	Teresa	Simon
01	Added a dimension		02/07/25	Teresa	Simon
02	Remove the top view and add a 3D diagram		02/26/25	Teresa	Simon

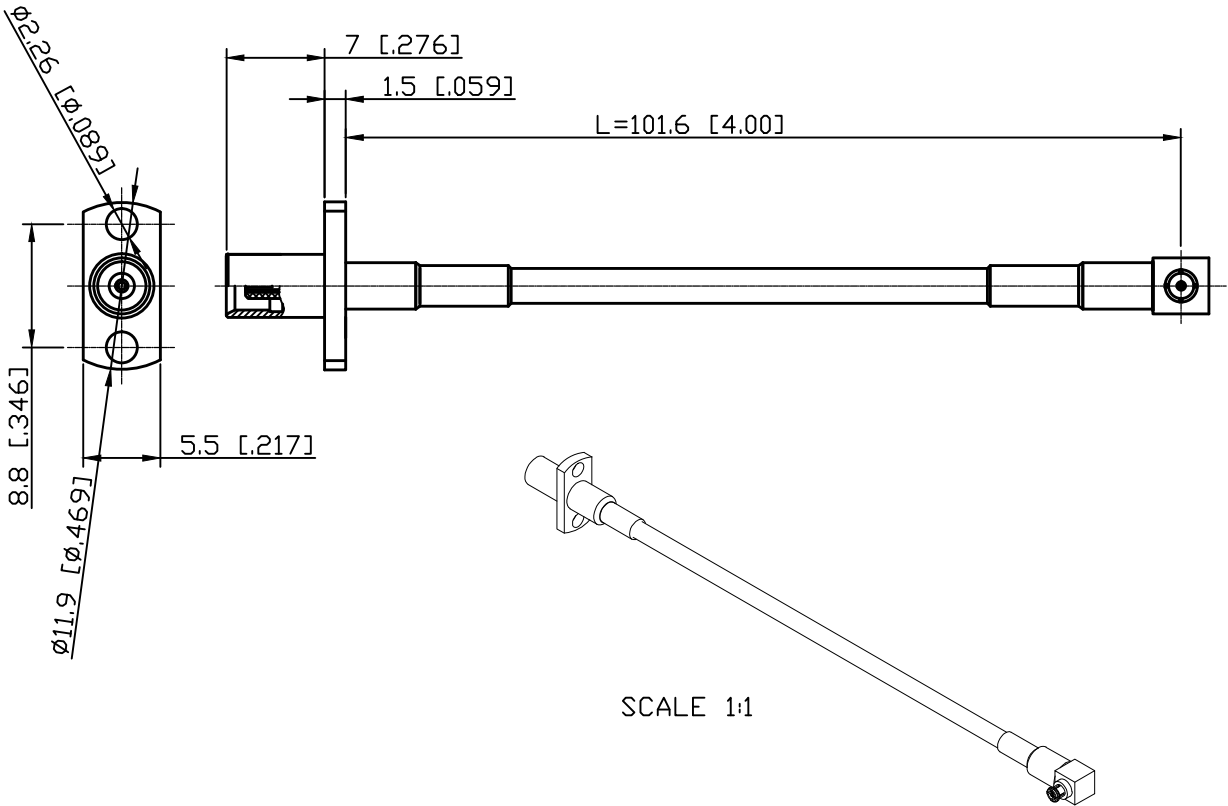

Material & Finishing:

MCX female

- Center conductor: Berillium Copper, Gold Plating
- Insulators: PTFE
- Body: Brass, Gold Plating

SMPM R/A female

- Center conductor: Berillium Copper, Gold Plating
- Insulators: PTFE
- Body: Berillium Copper, Gold Plating
- cover: Brass, Gold Plating

Electrical Data:

- Impedance: 50 Ohms
- Frequency Range: DC to 6 GHz
- VSWR: 1.5 MAX.

Mechanical Data:

- Durability: 500 cycles

ALL DIMENSIONS ARE IN MILLIMETERS AND [INCHES]

LIJEN, LLC from KERUI

Title  
Cable Assembly MCX Female Flange to SMPM R/A  
Female with .086 semi-flexible cable  
(MCX-KF086/SMPM-KW086)

THESE DRAWING & SPEC. ARE THE  
PROPERTY OF KERUI ELECTRONIC  
CO.,LTD AND SHALL NOT BE  
REPRODUCED, OR COPIED OR USED  
AS THE BASIS FOR THE  
MANUFACTURE OR SALE OF  
APPARATUS OR DEVICES WITHOUT  
THEIR EXPRESS WRITTEN CONSENT.

UNLESS OTHERWISE NOTED  
ALL SURFACES FINISHED TO 64/MAX.

ALL TOLERANCES ARE:

DECIMALS	FRACTIONS	ANGLES
x ± 1.0	±1/64	x' ± 1°
x.x ± 0.5		x'x' ± 0.5°
x.xx ± 0.1		

Drawn by  
Teresa

Ckd by  
Simon

Appd by  
Richard

Date  
02/05/2025

Scale  
1.5:1

Sheet 1 of 1

C392062 29 33 02-L